



INFORMATIONS FOR EXHIBITORS AND SPONSORS

Palais des Congrès
September 4 - 8, 2022
Bordeaux, France



*Innovative Biomaterials and
Translational Research*

For more information please visit esb2022.org



Content

1. Invitation to ESB 2022
2. Topics
3. Sponsorship, Support and Advertisement
 - Industrial exhibition
 - Sponsorship packages
 - Other Sponsorship Opportunities
4. Conference Venue
5. General Information
6. How to reach Bordeaux?
7. Accommodation
8. Sponsor and Exhibitor Application Form
9. ESB 2022 – General Terms and Conditions



1. Invitation to ESB 2022

Dear Sponsors,

It is our pleasure to invite you to the 32nd Annual Conference of the European Society of Biomaterials which will take place from September 4 to 8, 2022 in Bordeaux, France, **as a face-to-face event**. After these difficult years, with restricted travels, we are excited to host this meeting **by re-engaging in rich scientific and informal exchanges** between attendees.

All ESB meetings attracted a **remarkably multidisciplinary group of participants as they bring together at a same and unique place**, researchers from various fields including chemistry, physics, biology, biomaterial science, tissue engineering and medicine. As a sponsor of the meeting, you can **address various markets as well as understand the current needs and trends in these fields**. It is also a unique opportunity to **share your most recent technological developments in terms of tools and services**. This meeting also provides an environment that is designed to foster innovative and collaborative thinking.

As a result, this meeting is an **ideal platform to find new collaborators to develop the technological advances of tomorrow**. With over 1000 participants expected from all European countries, but also many distinguished guests from around the world, the ESB meeting is the first scientific event to reach the European Biomaterials and Regenerative Medicine scientific community.

One of the key missions of ESB meetings is to promote interactions between basic researchers, applied scientists, clinicians, and industry to drive the development of innovative solutions for clinical applications. We keenly understand that these new solutions to repair or produce tissues or organs will come from the combination of fundamental knowledge, multidisciplinary development efforts, as well as advances in production/analytic/imaging/communication tools. Accordingly, **your participation to this meeting is crucial to promote the translation of our scientific activity into clinical reality with added value for all stakeholders**.

We offer attractive sponsoring packages that combine various ways to be recognized a leader in your field (see pages 5-7). In addition, various sponsoring options are available to reach attendees (page 8), and **we remain open to specific sponsoring options to meet your needs**.

Bordeaux has its own international airport and is easily accessible from the biggest European hubs (Paris, Amsterdam, London, Madrid, Rome). It is connected to Paris by a TGV train (2 hours). The meeting venue is the *Palais des Congrès*. This spacious meeting space is located in northern Bordeaux and connected to the city center by a state-of-the-art tramway system. Booths of various sizes are available for rental. They will sit at the heart of the meeting where coffee, food and poster will be located. Boasting exceptional classical and modern architecture, and surrounded by the most famous vineyards in the world, Bordeaux is a perfect symbol of the French "Art of Living".

Please come and join us at the ESB 2022 meeting to share your ideas and discover our hospitality.

Kindest regards

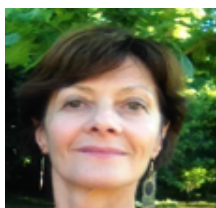

Joëlle Amédée, Chair



Jean Christophe Fricain, Co-chair



Didier Letourneur, Co-chair



2. Topics

Main topics of the conference include but are not limited to:

- Biocompatibility of biomaterials
- Cell & tissue material interfaces
- Bioceramics and bioactive glasses
- Basic science in hydrogel
- Disruptive concept in biomaterials
- Inflammation and biomaterials
- Textiles and fibers
- Biomaterial bioimaging
- Biomimetic and bioinspired materials
- Immunocompetent biomaterials
- Biomaterials for drug delivery
- 3D bioinks and matrices
- Hydrogels
- Bioprinting
- Biomaterials and organ on chips
- Organoids
- Immunomodulatory biomaterials
- Clinical evaluation of medical devices
- Biosensors and bioelectronics
- Vascular tissue engineering
- Supramolecular biomaterials
- Surface functionalization
- Biomaterial microenvironment
- Nerve tissue engineering
- Osteoarticular tissue engineering
- Transfer and commercialization of biomaterials
- Legal and regulatory aspects



3. Sponsorship, Support and Advertisement

Financial supports of companies, industry, organizations, regional actors are one of the key elements in the success of ESB congresses. On the following pages, various exhibition and sponsorship options are listed so you may select a combination that will fit your company's budget and marketing needs. Please note that booking an exhibition space qualifies you automatically to be listed as a sponsor.

3.1 Industrial Exhibition

Companies and organizations are cordially invited to present their services and products at the ESB 2022 conference.

The exhibition will take place from Sunday 4, September till Thursday, 8 September at the Palais des Congrès de Bordeaux, close to the Plenary Session auditorium and connected to all Parallel sessions. We encourage you to register early to avoid disappointment.

Poster sessions, coffee breaks and lunches of the conference are located in the same area to encourage interactions between the industrial exhibition and the conference participants.

The purpose of the exhibition program is to present products and/or services relevant to the participant's professional interests. The exhibitors should emphasize instruments, products or services for use in teaching and research, books and other publications in scientific fields of relevance to the interests of the participants.

Four sessions dedicated to technological aspects (5th and 6th September) supported by companies will be organized during the ESB 2022 conference. If you plan to present in one of these sessions through flash presentations, your expertise, materials, instruments and their applications, please submit your proposal to the organizers (see the application form pages 14-15).

Bordeaux Events, chair and co-chairs reserve the right, at its sole discretion, to accept or deny applications for exhibition space and to allocate space among exhibitors.

For all questions please contact: contact@esbbordeaux2022.org

Rental fee for space only

EUR 500 ¹⁾ per sq.m

¹⁾ If we receive your booking and payment **by January 06, 2022**, a discount of 10% will be applied

This basic package includes:

- minimum space 6 m² (3 x 2 m)
- Company description (10 lines & logo) in the final program distributed to all delegates
- Link to your company homepage from the exhibition page of the conference website
- 1 full congress registration for booth staff (includes regular sessions, coffee breaks and lunches)

⇒ *Please note: this option does not include a physical stand (no back wall, no side walls). We recommend ordering booth building. Orders for system stands, additional stand equipment, etc. can be ordered from the conference by using forms that will be sent to you (about 4 months before the conference (extra costs)).*

Please note an attractive sponsorship with competitive price for small start-up (less than 10 employees): EUR 1 500 ¹⁾ including a space 4 m² within the start-up area.



Equipped Exhibition Stand - Shell Scheme Booth

- 6 sq.m (3 x 2 m) EUR 3.700 ¹⁾
- 9 sq.m (3 x 3 m) EUR 5.300 ¹⁾
- 12 sq.m (4 x 3 m) EUR 7.000 ¹⁾

Bigger exhibition stands can be provided upon request

¹⁾If we receive your booking and payment **by January 06, 2022, a discount of 10 % will be applied**

The package for equipped exhibition stand includes the basic package services plus:

- Carpeted space (grey)
- Wall panels (side and back walls- corner booths with 2 open sides)
- Fascia board with company name (max. 16 letters)
- 1 table and 2 chairs
- Electrical connection 3 kW (single phase 230 V) with 1 x 3 way socket
- 3 Spotlights
- Company description (10 lines & logo) in the final program distributed to all delegates
- Link to your company homepage from the exhibition page of the conference website

How to order

- Exhibition space can be booked *via* the **enclosed application form pages 14-15**. It can be sent by email to: contact@esbbordeaux2022.org
- Applications for space must be received **by June 30, 2022** to be listed in the exhibition publication. Bordeaux Events reserves the right to short-term changes.
- If we receive your booking and payment **by January 06, 2022, a discount of 10 % will be applied**.

Exhibitor Technical Manual

A detailed manual including all relevant information for exhibitors such as technical aspects for exhibiting, final schedule and deadlines as well as additional order possibilities will be provided in the beginning of 2022.

Liabilities / Terms and conditions:

Space assignment will be made on a first come, first served basis. Wherever possible, space will be allotted according to the exhibitor's choice, but the final arrangement will be determined by Bordeaux Events in such a way as to produce the most advantageous grouping of the exhibition. There is no claim for a special exhibition space. There is no guarantee to any specific stand area within the exhibition area.

The exhibitor covers all other costs and risks in relation to the building and the construction and the support of the company's stand and has to provide an insurance policy against civil liability and damages. The total costs of the exhibition space must be paid before installation; otherwise, you are not allowed to install the booth.

Storage, Set up and dismantling:

Because of the limited storage space, we cannot guarantee to fulfill all requirements concerning the storage. Please take this into consideration for the delivery of your material. Bordeaux Events assumes no liability for damage and theft. Times for set up and dismantling as well as information on sending materials will be in the exhibition technical guide you will receive at the end of May 2022.

For all questions please contact: contact@esbbordeaux2022.org



3.2 Sponsoring Packages

Gold EUR 15.000 (Maximum 10 companies)

- Exhibition space, max. 12 sq. m.
- 3 full conference registrations* and tickets to the Gala Dinner
- Limit of 2 additional persons per exhibitor registration** at a reduced rate of € 250.00
- Your company will be acknowledged as “Gold sponsor” in the final program
- A priority to participate to the Technological sessions during the Conference
- Full color page advertisement inside page in the Final program
- Your logo on the ESB 2022 official website
- 1 link on the conference official website with redirection to your website
- Company description (10 lines & logo) in the final program distributed to all delegates
- On-site Placement of company banner

Silver EUR 10.000

- Exhibition space, max. 9 sq. m.
- 2 full conference registrations* and tickets to the Gala Dinner
- Limit of 2 additional persons per exhibitor registration** at a reduced rate of € 250.00
- Your company will be acknowledged as “Silver sponsor” in final program
- Full color page advertisement on inside page in the Final program
- Your logo on the ESB 2022 official website
- 1 link on the conference official website with redirection to your website
- Company description (10 lines & logo) in the final program distributed to all delegates

Bronze EUR 5.000

- Exhibition space, max. 6 sq. m.
- 1 full conference registration* and ticket to the Gala Dinner
- Limit of 1 additional person per exhibitor registration** at a reduced rate of € 250.00
- Your company will be acknowledged as “Bronze Sponsor” in final program
- Full color page advertisement on inside page in the Final program
- Your logo on the ESB 2022 official website
- 1 link on the conference official website with redirection to your website
- Company description (10 lines & logo) in the final program distributed to all delegates

* Registration includes entrance to all regular sessions, coffee breaks, lunches, welcome reception

** access only to the exhibition hall

Sponsoring options can be booked *via* the enclosed application form. It can be sent by email to:

contact@esbbordeaux2022.org



3.3 Other Sponsorship Opportunities

Your Logo on USB Memory Stick: EUR 3.000 (Exclusive sponsor)

The conference organizers will provide a USB Pen Drives (8 GB) that will contain the abstracts of the ESB 2022 conference.

Pocket program in the conference badges: EUR 3000 (6 sponsors)

The pocket program with program overview will be inserted into the conference badges. The company logo of the sponsor will be featured on the cover of the pocket program together with ESB 2022 logo.

Coffee break or lunch break (each): price on request

You have the opportunity to sponsor the coffee breaks or lunch breaks. The sponsor will obtain:

- Company logo beside the congress logo on the catering tables
- Roll-ups (supplied by the company) may be displayed in the catering area on the day of sponsorship
- Acknowledgement in the final program and on the conference official website

Welcome Reception: price on request

On Sunday, 4th September 2022, there will be a Welcome Reception for all registered participants. Interested companies have the opportunity to sponsor this event, which will take place in the exhibition area. It offers a perfect networking opportunity. The sponsor will obtain:

- Company logo on the catering tables
- Roll-ups (supplied by the company) will be displayed in the exhibition area
- 2 complimentary invitations to Welcome reception
- Oral acknowledgement during the Welcome reception
- Acknowledgement in the final program and on the conference official website

Gala Dinner: price on request

Sponsoring the Gala Dinner will provide the company with an opportunity to interact with all delegates. The sponsor will obtain:

- Company logo on the menu card
- Oral acknowledgement from conference chair
- Acknowledgement in the final program and on the conference official website
- 4 tickets to the Gala Dinner

Lanyards (to be provided by the sponsor): EUR 2 000 (Exclusive sponsor)

You can provide the lanyards distributed to all delegates upon the registration in Bordeaux, France (estimated 1.200 lanyards must be supplied by your company). Please ask Bordeaux Events for information about the requirements for lanyards.

Post-Graduate's Lunch: EUR 3.000 (two sponsors)

Opportunity for two sponsors to host one-hour lunchtime symposium for 40 Post-graduates (exact day and time will be decided by the program committee). The sponsor will structure the session's content and procurement of speakers. A final review will be made by the program committee. However, support can be also given to identify relevant speakers. The organizers will provide a room. If the sponsor requires any specific technical equipment or catering, this will be an additional cost.



Conference WiFi: EUR 5.000 (Exclusive sponsor)

Conference delegates will be using WiFi throughout the ESB 2022. As the WiFi sponsor, delegates will see your logo whenever they log into the conference WiFi network. This offer includes:

- Wifi login information cards with sponsor logo handed to each delegate upon check-in at the conference registration desk
- Acknowledgement in the final program and on the conference official website
- Complimentary exhibition booth space, max. 6 sq. m. including table with table cover, 2 chairs and power supply

ESB 2022 Water bottle: EUR 4.000 (Exclusive sponsor)

This offer includes:

- Company logo on the Water bottle
- Acknowledgement in the final program and on the conference official website
- 4 tickets to the Gala Dinner

Other Ideas or special requests?

Tailor-made packages can be arranged to suit your special requests. Feel free to contact the Congress Organization to discuss your needs (contact@esbbordeaux2022.org)

4. Conference Venue

The Palais des Congrès, Bordeaux, is located in front of the Bordeaux Lake district, which offers an environment between nature and conviviality. This congress center is directly accessible by tramway from the St Jean Rail Station in 30 minutes and from the City Centre in 20 min. Accommodations, more than 1400 rooms, are within walking distance of Conference venue.



Palais des Congrès
Avenue Gabriel
Domergues
33300 BORDEAUX, France

The Palais des Congrès offers all facilities and technical requirements for hosting large international conferences and promoting interactive discussions in various auditorium and halls at the two levels.

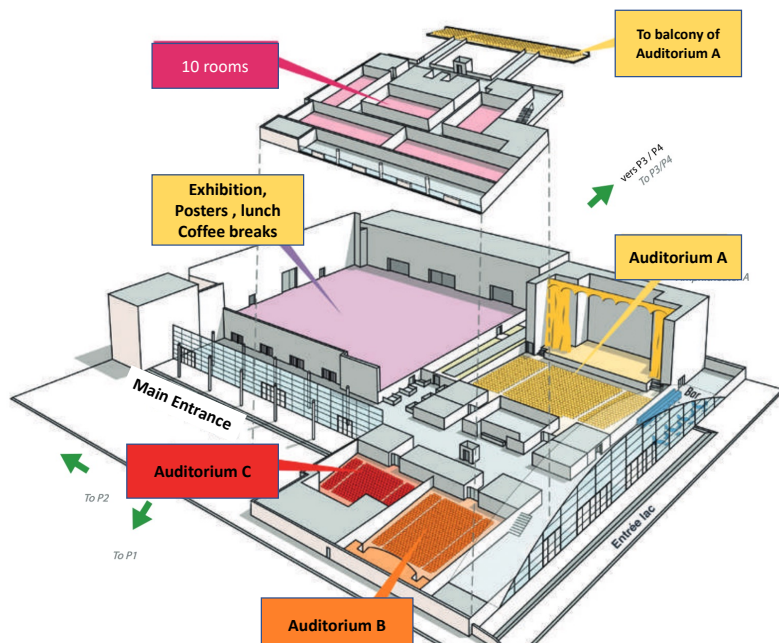

Ground level

- 1080 sqm for the Lobby and access to the auditorium and the first level
- Auditorium A: Plenary session for up to 1290 participants
- Auditorium B: Plenary session for up to 350 participants
- Auditorium C: Plenary session for up to 190 participants

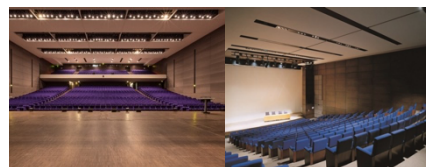

Exhibition area, Posters, catering and lunch in a 3 000 sqm area gross, directly located close to the auditorium A, B and C. This spacious Exhibition area will be located close to Plenary Session and Parallel sessions

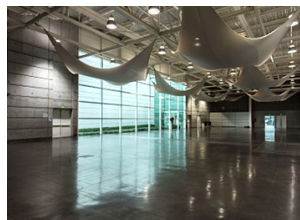

It will host the exhibitor stands, the coffee and lunch break area as well as part of the poster presentations area. Thus, a constant frequentation at the booths will be guaranteed to maximize networking opportunities. In order to promote visits in the exhibition hall, we also plan to organize specific meetings and lunch meetings between company's representatives and young researchers during the lunch break.

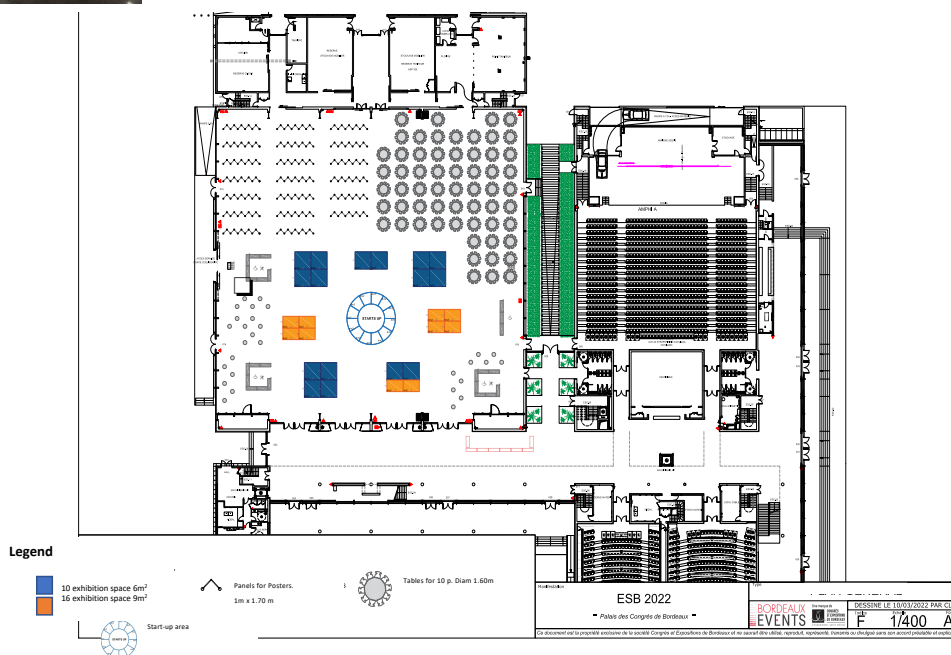



First level

10 meeting rooms (80 to 180 seats) for the 3 other parallel sessions, symposia, and meetings (ESB Council Committee, European meeting programs, Post doc lunch symposia: Meet the Professors or the industrials...).



Preliminary program

SUN. 4 SEPT.	MON. 5 SEPT.	TUE. 6 SEPT.	WED. 7 SEPT.	THU. 8 SEPT.
	Registration 08:00-08:30			
	Plenary Lecture 08:30-09:15 Award (Jean Leray Award) 09:15-10:00 Coffee Break & Posters 10:00-10:45 Parallel Sessions S1, S2, S3, S4, S5 10:45-12:30 Technological Session 1 45 min 10:45-11:30 Technological Session 2 60 min 11:30-12:30	Plenary Lecture 08:30-09:15 Award (George Winter Award) 09:15-10:00 Coffee Break & Posters 10:00-10:45 Parallel Sessions S12, S13, S14, S15, S16 10:45-12:30 Technological Session 3 45 min 10:45-11:30 Technological Session 4 60 min 11:30-12:30	Plenary Lecture 08:30-09:15 Award (Klaas de Groot Award) 09:15-10:00 Coffee Break & Posters 10:00-10:45 Parallel Sessions S24, S25, S26, S27, S28 10:45-12:15 European Projects Symposium 10:45-12:15 General Assembly ESB 12:15-13:15	Parallel Sessions S41, S42, S43, S44, S45, S46 08:30-09:45 Coffee Break & Posters 09:45-10:30 Parallel Sessions S47, S48, S49, S50, S51, S52 10:30-12:15 Closing Ceremony 12:15 - 12:45 End of the Conference 12:45-13:00 Lunch Boxes 13:00
	Lunch Break & Meetings with Industrials and Professors 12:30-13:30			
	Poster Session 1 13:30-14:30 Award (International Award) 14:30-15:15 Parallel Sessions S6, S7, S8, S9, S10, S11 15:30-16:30 Coffee Break & Posters 16:30-17:15 Parallel Interventions Canadian society Chinese Society South American Society Royal Society & Biomaterial Science Korean Society Biomat Society 17:15 - 18:45 End of the Sessions 18:45	Poster Session 2 13:30-14:30 Plenary Lecture (Clinical Applications) 14:30-15:15 Parallel Sessions S17, S18, S19, S20 15:30-16:30 Clinical Session 1 15:30-16:30 Transnational Session 1 15:30-16:30 Coffee Break & Posters 16:30-17:15 Parallel Sessions S21, S22, S23 17:15-18:15 Workshop Young Scientist 17:15-18:15 Clinical Session 2 17:15-18:15 Transnational Session 2 17:15-18:15 General Assembly Young Scientist Forum 18:30 - 19:30 End of the Sessions 19:30 Young Scientist Forum's Night 20:15	Lunch Break & Posters 13:15-14:15 Fellow Contest 14:15-15:30 Parallel Sessions S29, S30, S31, S32, S33, S34 15:45-16:30 Coffee Break & Posters 16:45-17:15 Parallel Sessions S35, S36, S37, S38, S39, S40 17:15-18:15 End of the Sessions 18:15 Bus Departures for Gala Diner 18:30 - 19:00	
Registration 14:00-16:00 Workshop Young Scientist 14:00-16:00 Registration & Coffee Break 16:00-17:30 Welcome Ceremony 17:30-18:00 Opening Lecture 18:00-19:00 Welcome Reception 19:00-21:00	Industrial Exhibition & Poster Exhibition	Industrial Exhibition & Poster Exhibition	Industrial Exhibition & Poster Exhibition	
		Return to the Congress Center or in Town 00:00		



5. General Information

Date / Exhibition hours	Sep 4, 2022	10:00 – 16:00	Set up
	Sep 4, 2022	16:30 – 19:00	
	Sep 5, 2022	08:30 – 19:00	Dismantling
	Sep 6, 2022	08:30 – 19:00	
	Sep 7, 2022	08:30 – 19:00	
	Sep 8, 2022	08:30 – 13:00	
	Sep 8, 2022	13:00 – 18:00	
Date / Conference hours	Sep 4, 2022	16:30 – 19:00	Gala dinner
	Sep 5, 2022	08:30 – 18:45	
	Sep 6, 2022	08:30 – 19:15	
	Sep 7, 2022	08:30 – 18:15	
	Sep 8, 2022	09:00 – 12:45	
Conference Chair	Dr Joëlle Amédée University of Bordeaux, Inserm U1026 Tissue engineering Laboratory (BIOTIS) Bordeaux France		
Co-Chairs	Pr Jean Christophe Fricain University of Bordeaux, Inserm U1026 Tissue engineering Laboratory (BIOTIS) Bordeaux, France		
	Dr Didier Letourneur University of Paris, University Sorbonne Paris Nord, Inserm U1148 Laboratory for Vascular and Translational Science (LVTS) Paris, France		
Organizing Secretariat	ESB 2022 Congress Organization BORDEAUX EVENTS Congrès et Expositions de Bordeaux Rue Jean Samazeuilh – CS 20088 33070 Bordeaux Cedex, France Phone: +33 (0)6 88 61 34 47 E-Mail: contact@esbbordeaux2022.org		
Expected number of participants	Approx. 1000 participants		
Conference language	English		
Venue	Palais 2 L'Atlantique, Bordeaux Lac		
Conference webpage	www.esb2022.org		
Smartphone Application	in progress		



6. How to reach Bordeaux ?

Bordeaux is located in South West of France, accessed by visitors from all countries from Europe.

By plane: The international airport Bordeaux Merignac is connected to 5 of the biggest European hubs (Paris Charles de Gaulle (1:20 hour by flight), Amsterdam, London, Madrid, Lisbon, Rome....). It provides more than 80 direct connections in Europe and a direct flight to Canada.

By train: Bordeaux can be easily reached by train from everywhere in France (2 hours from Paris) (<https://www.oui.sncf/>)

Public transportation in Bordeaux: Within Bordeaux, a modern and efficient public transportation system with trams and buses is available.

From the airport, guests can take the bus connecting the airport with the City Centre (30 min).

From the City Centre: Tramway C and stop at "Parc des Expositions / Nouveau stade".

From the rail station: Tramway C and stop at "Parc des Expositions / Nouveau stade"



7. Accommodation

With more than 14 000 rooms in 200 hotels, Bordeaux displays a large choice of hotel rooms (from 2★ to 5★), in downtown (1); close to the Palais des Congrès (less than 5 minutes by foot; (2); 1 400 hotel rooms close to the airport (3); or the rail station (4).

1 Downtown: 3 950 rooms

1. 213 rooms 5★
2. 955 rooms 4★
3. 1 030 rooms 3★
4. 911 rooms 1 to 2★
5. 841 flats 3 to 4★

2 Close to the Palais des Congrès: 1 400 rooms

6. 441 rooms 4★
7. 364 rooms 3★
8. 180 rooms 1 to 2★
9. 200 apartments 3★

3 Merignac Airport: 2 220 rooms

10. 361 rooms 4★
11. 399 rooms 3★
12. 716 rooms 1 to 2★
13. 654 apartments 3 to 4★

4 Rail station: 275 rooms 4★

Palais des Congrès

After your online registration, please book your favorite room directly in the hotel. If there is any way we can be of assistance regarding the booking process please do not hesitate to contact us:

contact@esbbordeaux2022.org



8. Sponsor and Exhibitor Application Forms

Deadline for Sponsor Application: June 30, 2022

Deadline for Exhibitor Application: June 30, 2022

If you are interested in participating in the ESB 2022 in Bordeaux, please complete the application form (use block characters). After receiving your application form, a contract will be sent to you.

Exhibitors will receive the exhibitor's manual including forms for additional services (booth system, electrical connection, furniture) around 2 months before ESB conference (End June 2022 at the latest).

ESB 2022 Congress Organization

BORDEAUX EVENTS

Congrès et Expositions de Bordeaux

Rue Jean Samazeuilh – CS 20088

33070 Bordeaux Cedex, France

Phone: +33 (0)6 88 61 34 47

E-Mail: contact@esbbordeaux2022.org

Sponsor / Company:	
Contact Person:	
Address: _____ _____	
Zip code: _____	City: _____ Country: _____
Invoicing address (if different): _____ _____	
Sales Tax ID No. / VAT number:	
Purchase order number (if necessary):	
Phone	email



Exhibition packages:

We would like to participate as an exhibitor and book the following exhibition stand.

☐ **Exhibition Stand – Space only**EUR 500¹⁾ per sq.m

Preferred exhibition space dimension (minimum space 6 m2):

_____ m width x _____ m depth = _____ sq. m.

☐ **Equipped Exhibition Stand – Shell Scheme Booth**

☐ **6 sq. m (3 x 2 m)** EUR 3.700¹⁾

☐ **9 sq. m (3 x 3 m)** EUR 5.300¹⁾

☐ **12 sq. m (4 x 3 m)** EUR 7.000¹⁾

☐ **other dimensions** _____ m width x _____ m depth = _____ sq. m. on request

¹⁾ in case of booking AND payment **until January 06, 2022** you receive a **discount of 10%**

Sponsorship packages:

We would like to book the following sponsorship package

☐ **Gold (Max. 4 companies)** EUR 15.000

☐ **Silver** EUR 10.000

☐ **Bronze** EUR 5.000

Please indicate the name on the fascia board (for shell scheme booths only; max. 30 letters):

.....

Special requirements:

Other Sponsorship Opportunities:

☐ **Your Logo on USB Memory Stick** (provided by organizer) EUR 3 000

☐ **Pocket Program in the Conference badges** EUR 3 000

☐ **Coffee Break** (each) On request

☐ **Lunch Break** (each) On request

☐ **Welcome Reception** On request

☐ **Gala Dinner** On request

☐ **Lanyards** (to be provided by the sponsor) EUR 2 000

☐ **Post graduate lunch symposium** EUR 3 000

☐ **Conference Wifi** EUR 5 000

☐ **ESB 2022 Water Bottles** EUR 4 000

☐ **Other ideas** (Please indicate) On request



9. ESB 2022 – General Terms and Conditions

By submitting the exhibitor/sponsor application form, the industry partner accepts these General Terms and Conditions.

The contract is legally binding upon signature of both parties. The permission to exhibit at the mentioned congress is granted through this contract and the corresponding invoice. The industry partner has to pay the total amount due to the congress account within 14 days after having received the invoice, at the latest. If the payment has not been realized in due time, the organizer has the right to reverse the permission and to distribute the requested exhibition space to another industry partner. Only after having received the payment in full, the booking will be officially accepted and the exhibition area will be considered bindingly reserved. A cancellation of the permission can also be made if the exhibits of the industry partner are not in accordance with the congress.

In case of cancellation by the industry partner, NO REFUND will be given, neither for booked exhibition space nor for any other ordered furniture/exhibition items or for booked sponsoring items.

An own company stand may only be assembled after a full booth construction plan has been submitted in due time to the organizer and is confirmed by both the congress venue and the congress organization. The industry partner accepts the safety regulations from the local authorities (police), the fire brigade, the Technical Inspection Agency and similar organizations at the congress site. Aisles, emergency exits, emergency lighting and fire extinguishing equipment may not be blocked or screened in any way at any time.

It is prohibited to hang stand constructions from the roof of the exhibition area, to drive nails or other fastenings in the walls or in rented stand walls, to bore or to pass own cables. Any additional furniture has to be approved and confirmed in a written way from the organizer. Furthermore, the organizer has to be informed about additional requirements in sufficient time. The industry partner is requested to deal carefully with the rented booth and furniture, and to hand it back afterwards in due time in proper condition.

Concerning the distribution of product samples, refreshments, food or any other items given to delegates on-site, the industry partner has to ask for a written confirmation of the organizer and the congress venue.

The assembling and dismantling of the booth have to be realized during the determined dates and times. In case of non-compliance, the organizer reserves the right to charge possibly resulting extra costs to the industry partner's account. The booth has to be occupied at any time during the official exhibition opening hours.

The exhibition costs do not include insurances of any kind. The industry partner takes the full liability for all damages caused by him or the staff. The organizer does not take any responsibility or liability for damages or losses at the booths or of the exhibits. All industry partners are advised to arrange appropriate insurances on their own.

The General Terms and Conditions of the congress centre (congress venue) as well as of all service partners apply additionally.